

NOTE:

- 1) INSTALL BUSHINGS WITH GROOVES FACING INWARD.
- 2) INSTALL SEALS WITH LIP FACING OUTWARD

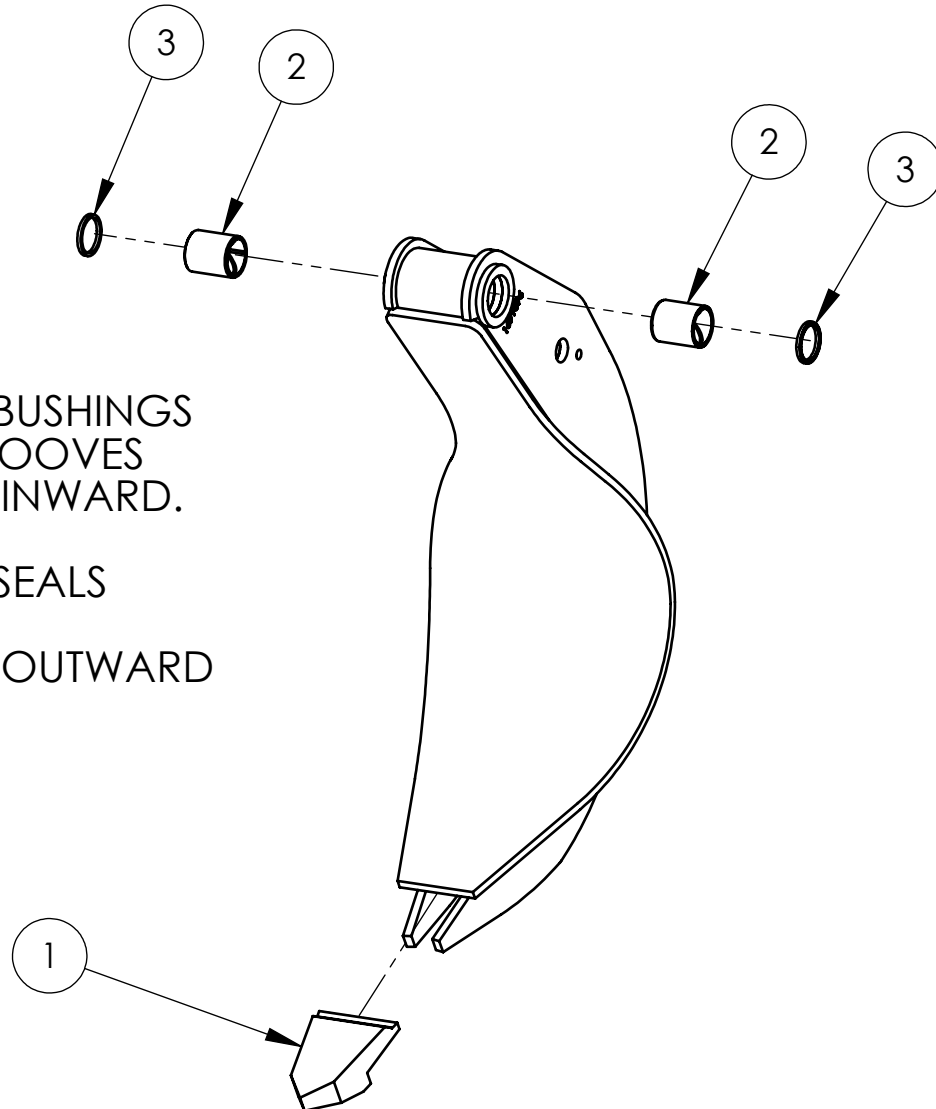

ITEM	QTY	PART NO.	DESCRIPTION
1	1	211W6	CASTING: LEG TIP
2	2	534W369	BUSHING, STEEL
3	2	2189P30047	METAL ENCASED ROD WIPER

PROPRIETARY  
INFORMATION

THE INFORMATION CONTAINED IN THIS DRAWING IS THE PROPERTY OF YOUNG CORPORATION SEATTLE WA.  
IT SHALL NOT BE COPIED OR DUPLICATED WITHOUT THEIR WRITTEN CONSENT.

**young**  
CORPORATION

169Y396 GRAPPLE LEG PARTS

DATE:  
10/5/2009

845VLO200C

**68-1**